

## SBC FILTER

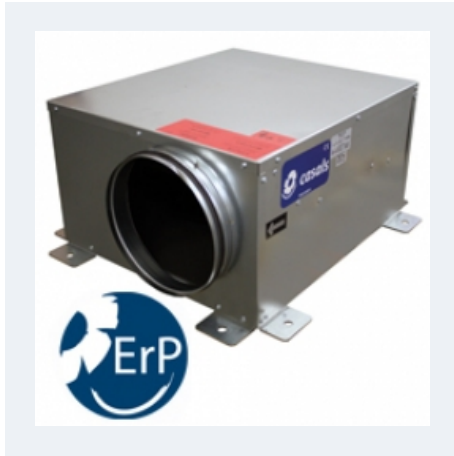

### CENTRIFUGAL LOW PROFILE BOX WITH FILTERS. EXTERNAL ROTOR MOTOR WITH CIRCULAR FLANGES

#### CONSTRUCTIVE FEATURES:

- Box manufactured in galvanized sheet with thermo-acoustic insulation, Bs1d0 fire class
- Circular connection flanges
- Two-stage filtration G4 and F7
- Asynchronous external rotor, which includes thermal protector and ball bearings permanently greased. IP-44 protection and insulation class B according to DIN 40.050 h1. Standard voltage 230V 50Hz.

#### APPLICATIONS:

Designed for inline installation, they are suitable for:

- Air renewal in bathrooms and small premises.
- Perfect for installing in false ceilings or open.
- Maximum working temperature: 50°C.

(\*) The data shown correspond to measurements made without the filters installed.

## Accessories



**FILTRO  
SB  
FILTER**



**INT**



**REG**



**REG  
VMC**



**REGD**

## Technical data

### Single-phase motor

Code	Model	R.P.M.	Rated I. (A) 230V	Rated power kW	Max. Airflow m3/h	Sound db (A)**	Weight	Connect. diagram
240160243CF	SBC FILTER 160	2290	0,27	0,06	320	39	13,50	1
240200243CF	SBC FILTER 200	2480	0,42	0,10	590	43	17	1
240250243CF	SBC FILTER 250	2530	0,82	0,19	860	48	21	1
240280243CF	SBC FILTER 280	2480	1,05	0,24	1.230	52	27	1
240310243CF	SBC FILTER 315	1380	0,6	0,14	1.070	36	32	1
240350243CF	SBC FILTER 355	1400	0,75	0,17	1.520	36	40	1
240400243CF	SBC FILTER 400	1350	1,2	0,26	1.820	39	60	1

**Notes:**

\*\* Total sound pressure level at the point of maximum flow measured in dB(A) in the suction measured in free field at a distance of 6m from the source

## Dimensions

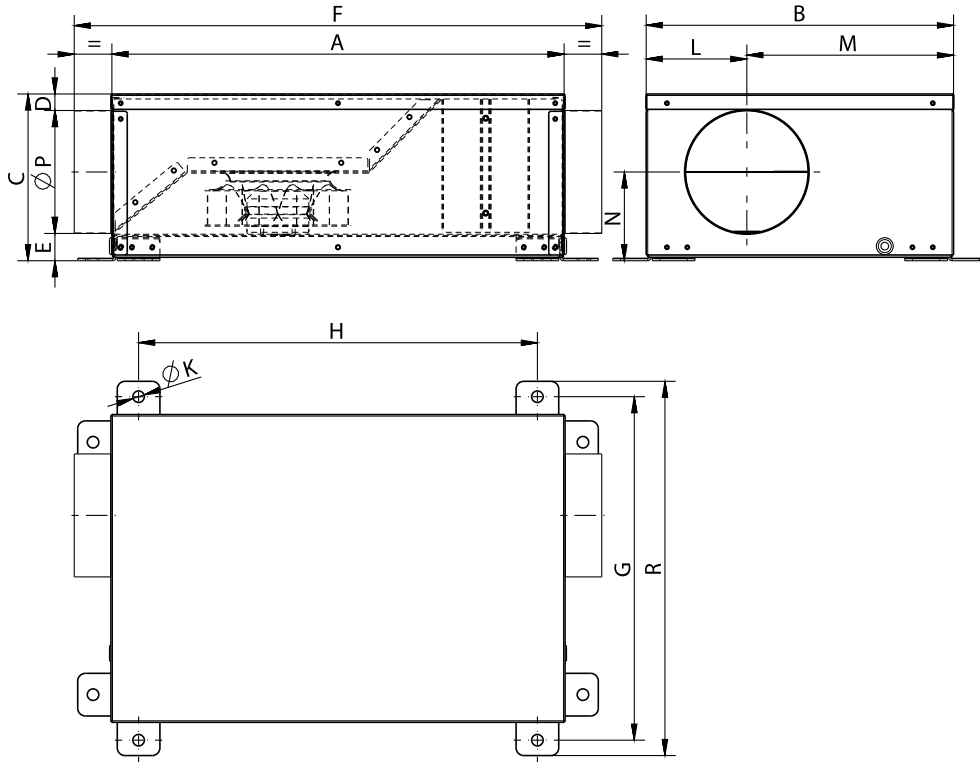

Model	A	B	C	D	E	F(aprox)	G	H	L
SBC FILTER 160	588,5	400	217	21.5	35.5	686,5	447	519	358
SBC FILTER 200	657	453	255,5	23	32.5	765	500	587,5	412
SBC FILTER 250	738,5	497	305,5	23	32.5	856,5	554	639	456
SBC FILTER 280	808,5	552	340,5	25.5	35	926,5	609	709	511
SBC FILTER 315	886	618	375,5	23	37.5	1004	675	786,5	577
SBC FILTER 355	977	692	445,5	37.5	53	1135	749	877,5	651
SBC FILTER 400	1083	777	475,5	38	37.5	1241	834	983,5	736

Model	M	N	R	ØK	ØP
SBC FILTER 160	269	487	487	15	160
SBC FILTER 200	302	540	540	15	200
SBC FILTER 250	321	604	604	15	250
SBC FILTER 280	361	659	659	15	280
SBC FILTER 315	409.5	725	725	15	315
SBC FILTER 355	463.5	899	799	15	355
SBC FILTER 400	526	884	884	15	400

## Wiring diagram

DIAGRAM N° 1

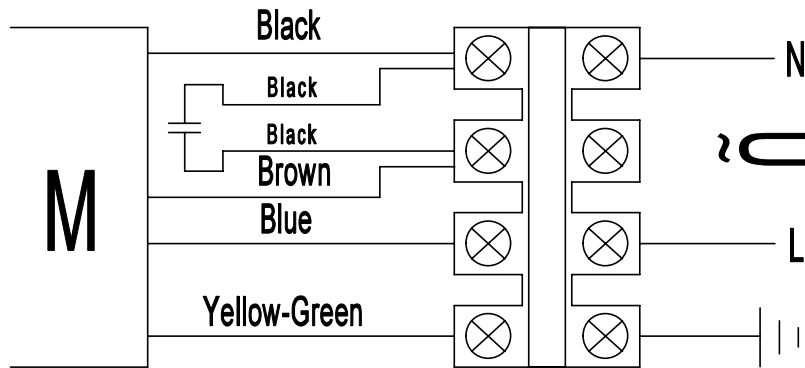

# CHARACTERISTIC CURVE

1	SBC FILTER 160	2	SBC FILTER 200	3	SBC FILTER 250	4	SBC FILTER 280
5	SBC FILTER 315	6	SBC FILTER 355	7	SBC FILTER 400		

## AIR FLOW - PRESSURE

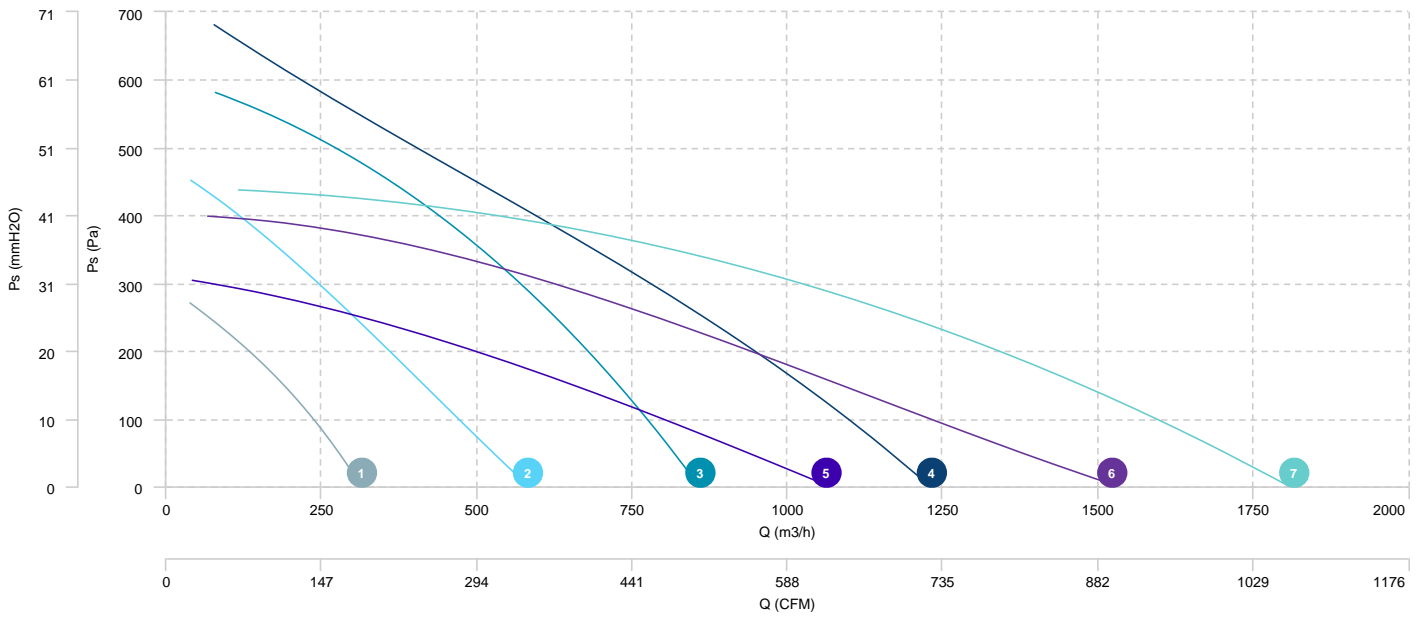

## AIR FLOW - ABSORBED POWER

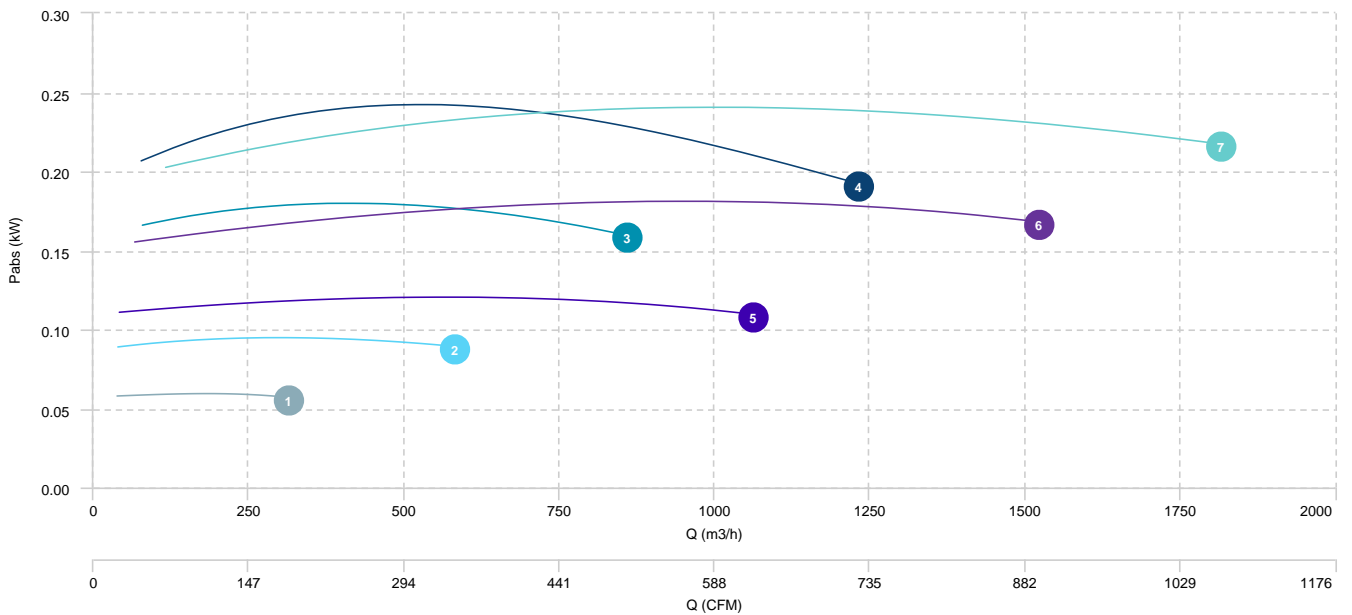

## Sound data

Sound power Lw dB (A)										
Model		63 Hz	125 Hz	250 Hz	500 Hz	1000 Hz	2000 Hz	4000 Hz	8000 Hz	Total
SBC FILTER 160	Inlet	62	60	53	48	47	44	41	36	65
SBC FILTER 200	Inlet	66	64	57	52	51	48	45	40	69
SBC FILTER 250	Inlet	71	69	62	57	56	53	50	45	74
SBC FILTER 280	Inlet	75	73	66	61	60	57	54	49	78
SBC FILTER 315	Inlet	59	57	50	45	44	41	38	33	62
SBC FILTER 355	Inlet	59	57	50	45	44	41	38	33	62
SBC FILTER 400	Inlet	62	60	53	48	47	44	41	36	65

**erp data**

ERP	
Fan type	Unit for non-residential ventilation (LOT 6)
Typology	Unidirectional
Others	Filter
Type of driver	None

Model	Motor power (kW)	Maximum efficiency point data						
		Eff.Heat recovery (%)	Max. efficiency (%)	Pabs (kW)	Air Flow (m3/h)	Ps (Pa)	Speed (m/s)	SFP (W/m3/s)
SBC FILTER 250	0,19	-	27,95	0,18	493,46	360,61	2.79	1.306,33
SBC FILTER 280	0,24	-	28,80	0,24	695,12	346,26	3.14	1.234,65
SBC FILTER 355	0,17	-	30,19	0,18	774,41	254,34	2.17	836,48
SBC FILTER 400	0,26	-	35,80	0,24	1.038,92	295,08	2.3	833,42