

MBX



CENTRIFUGAL MEDIUM PRESSURE ATEX FAN

MANUFACTURING FEATURES

- Rolling steel sheet housing.
- Completely joined or welded housing.
- Simple inlet forward curved impeller made of aluminium sheet.
- Polyester powder finishing coat.
- Inlet sparkproof ring made of copper or aluminium.
- ATEX standard asynchronous motor. ATEX certified: II2G Ex-d, Ex-e / II3GD Ex-nA. Standard voltages 230V 50Hz for single phase motors and 230/400V 50Hz for three phase motors. IP55 protection, and class F insulation. Manufactured with standard voltages: 230/400V 50Hz in three phase motors up to 4kW and 400/690V 50Hz for higher powers.
- Standard orientation: LG270.

APPLICATIONS

- Designed for inline installation, they are suitable for:
- Ventilation in indoor environments classified as ATEX
 - Maximum air working temperature from -20°C to 80°C.

UNDER REQUEST

- 60Hz fans and special voltages.
- ATEX classification for other areas
- Orientation: RD0, RD45, RD90, RD135, RD180, RD225, RD270, RD315, LG0, LG45, LG90, LG135, LG180. LG225, LG315.

ORGANISM: L.O.M.
 CERTIFICAT N°: LOM 17.407N-C

In compliance with the Directive 2014/34/UE

Accessories



AB



AC



AVR



AVS



BA-400



BAD



EI



FS



INT ATEX



JE 45



RA



RBS



SFC

Technical data

Single-phase motor / 2 poles

Code	Model	R.P.M.	Rated I. (A) 230V	Rated power kW	Max. Airflow w m3/h	Sound db (A)**	Weight t	Connect. diagram
253100103XD	MBX 14/5 M2 0,25kW	2800	-	0,25	830	58	7	1
253110103XD	MBX 16/6 M2 0,37kW	2800	-	0,37	1.340	60	9,50	1
253170103XD	MBX 18/7 M2 0,75kW	2800	-	0,75	1.940	63	15	1
253240103XD	MBX 20/6 M2 0,37kW	2800	-	0,37	800	61	14	1
253190103XD	MBX 20/8 M2 1,1kW	2820	-	1,10	2.240	65	19	1

Single-phase motor / 4 poles

Code	Model	R.P.M.	Rated I. (A) 230V	Rated power kW	Max. Airflow w m3/h	Sound db (A)**	Weight t	Connect. diagram
253080103XD	MBX 12/5 M4 0,08kW	1370	-	0,08	240	46	5	1
253090103XD	MBX 14/5 M4 0,08kW	1370	-	0,08	420	46	6	1
253150103XD	MBX 16/6 M4 0,08kW	1370	-	0,08	710	53	7,50	1

Three-phase motor / 2 poles

Code	Model	R.P.M.	Rated I. (A) 400V	Rated power kW	Max. Airflow w m3/h	Sound db (A)**	Weight t	Connect. diagram
253100106X_	MBX 14/5 T2 0,25kW	2800	0,74	0,25	830	58	7	1
253110106X_	MBX 16/6 T2 0,37kW	2800	1	0,37	1.340	60	9,50	1
253170106X_	MBX 18/7 T2 0,75kW	2800	2	0,75	1.940	63	15	1
253240106X_	MBX 20/6 T2 0,37kW	2800	1	0,37	800	61	14	1
253190106X_	MBX 20/8 T2 1,1kW	2800	2,6	1,10	2.240	65	19	1
253210120X_	MBX 22/9 T2 1,1kW	2800	2,6	1,10	1.570	55	24	1
253200106X_	MBX 22/9 T2 2,2kW	2800	5,4	2,20	2.750	65	30	1
253280106X_	MBX 25/10 T2 2,2kW	2800	5,4	2,20	2.550	62	32	1
253290106X_	MBX 25/10 T2 3kW	2870	7,3	3	3.700	66	38	1
253360106X_	MBX 28/11 T2 4kW	2890	9,2	4	3.800	70	46	1

Three-phase motor / 4 poles

Code	Model	R.P.M.	Rated I. (A) 400V	Rated power kW	Max. Airflow w m3/h	Sound db (A)**	Weight	Connect. diagram
253080106X_	MBX 12/5 T4 0,08kW	1400	0,46	0,08	250	46	5	1
253090106X_	MBX 14/5 T4 0,08kW	1400	0,46	0,08	420	46	6	1
253150106X_	MBX 16/6 T4 0,08kW	1400	0,46	0,08	710	53	7,50	1
253260106X_	MBX 22/9 T4 0,37kW	1400	1,2	0,37	1.930	59	21	1
253320106X_	MBX 25/10 T4 0,75kW	1390	2,1	0,75	2.530	59	26	1
253410106X_	MBX 28/11 T4 1,1kW	1400	3,3	1,10	3.490	65	32	1
253420106X_	MBX 31/12 T4 2,2kW	1430	5,8	2,20	6.160	63	54	1
253480106X_	MBX 35/14 T4 3kW	1430	6,8	3	6.500	65	63	1
253490106X_	MBX 35/14 T4 4kW	1440	9,1	4	8.290	64	69	1
253510121X_	MBX 40/16 T4 5,5kW	1440	11,5	5,50	9.000	68	101	1
253510106X_	MBX 40/16 T4 7,5kW	1440	15,6	7,50	11.500	72	110	1
253530120X_	MBX 45/18 T4 7,5kW	1440	15,6	7,50	9.500	75	119	1
253530121X_	MBX 45/18 T4 11kW	1460	20,9	11	14.000	76	190	1

Three-phase motor / 6 poles

Code	Model	R.P.M.	Rated I. (A) 400V	Rated power kW	Max. Airflow w m3/h	Sound db (A)**	Weight	Connect. diagram
253500106X_	MBX 35/14 T6 1,1kW	910	4	1,10	5.170	58	53	1
253520106X_	MBX 40/16 T6 1,5kW	940	4	1,50	5.800	59	94	1
253560106X_	MBX 45/18 T6 2,2kW	940	5,2	2,20	6.800	64	112	1

Notes:

** Total sound pressure level at the point of maximum flow measured in dB(A) in the suction measured in free field at a distance of 6m from the source

Dimensions

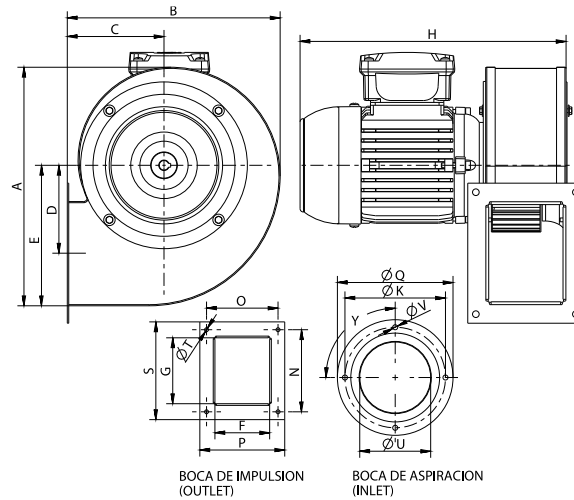

Model	A	B	C	D	E	F	G	H	K
MBX 12/5 M4 0,08kW	205,5	188	87	71,5	117	72	85	251	135
MBX 12/5 T4 0,08kW	205,5	188	87	71,5	117	72	85	251	135
MBX 14/5 M2 0,25kW	250,5	224	102	93	147,5	82	106	278	162
MBX 14/5 M4 0,08kW	250,5	224	102	93	147,5	82	106	278	162
MBX 14/5 T2 0,25kW	250,5	224	102	93	147,5	82	106	278	162
MBX 14/5 T4 0,08kW	250,5	224	102	93	147,5	82	106	278	162
MBX 16/6 M2 0,37kW	295	266	119	108	171,5	100	120	325	180
MBX 16/6 M4 0,08kW	295	266	119	108	171,5	100	120	298	180
MBX 16/6 T2 0,37kW	295	266	119	108	171,5	100	120	325	180
MBX 16/6 T4 0,08kW	295	266	119	108	171,5	100	120	298	180
MBX 18/7 M2 0,75kW	350	305	130	133	205	115	140	358	214
MBX 18/7 T2 0,75kW	350	305	130	133	205	115	140	358	214
MBX 20/6 M2 0,37kW	347	302	132	150	202	105	100	329	230
MBX 20/6 T2 0,37kW	347	302	132	150	202	105	100	329	230
MBX 20/8 M2 1,1kW	374	320	138	139	221	130	160	372	230
MBX 20/8 T2 1,1kW	374	320	138	139	221	130	160	372	230

Model	N	O	P	Q	S	TØ	UØ	VØ	Y
MBX 12/5 M4 0,08kW	105	93	106	150	118	7	92,5	7	4x90º
MBX 12/5 T4 0,08kW	105	93	106	150	118	7	92,5	7	4x90º
MBX 14/5 M2 0,25kW	128	105	123	175	147	7	115	7	4x90º
MBX 14/5 M4 0,08kW	128	105	123	175	147	7	115	7	4x90º
MBX 14/5 T2 0,25kW	128	105	123	175	147	7	115	7	4x90º
MBX 14/5 T4 0,08kW	128	105	123	175	147	7	115	7	4x90º
MBX 16/6 M2 0,37kW	147	128	152	207	172	7	127	9	4x90º

Model	N	O	P	Q	S	TØ	UØ	VØ	Y
MBX 16/6 M4 0,08kW	147	128	152	207	172	7	127	9	4x90º
MBX 16/6 T2 0,37kW	147	128	152	207	172	7	127	9	4x90º
MBX 16/6 T4 0,08kW	147	128	152	207	172	7	127	9	4x90º
MBX 18/7 M2 0,75kW	169	146	169	237	192	8	143	9	4x90º
MBX 18/7 T2 0,75kW	169	146	169	237	192	8	143	9	4x90º
MBX 20/6 M2 0,37kW	128	134	159	255	153	8	161	9	8x45º
MBX 20/6 T2 0,37kW	128	134	159	255	153	8	161	9	8x45º
MBX 20/8 M2 1,1kW	189	160	184	255	213	8	161	9	8x45º
MBX 20/8 T2 1,1kW	189	160	184	255	213	8	161	9	8x45º

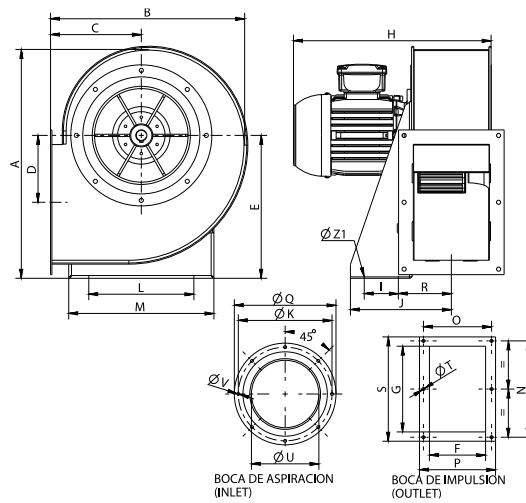

Model	A	B	C	D	E	F	G	H	I
MBX 22/9 T2 1,1kW	447	382	181	134	280	140	216	403	50
MBX 22/9 T2 2,2kW	447	382	181	134	280	140	216	439	50
MBX 22/9 T4 0,37kW	447	382	181	134	280	140	216	403	50
MBX 25/10 T2 2,2kW	496	420	197	142	310	165	254	463	74
MBX 25/10 T2 3kW	496	420	197	142	310	165	254	498	74
MBX 25/10 T4 0,75kW	496	420	197	142	310	165	254	427	74
MBX 28/11 T2 4kW	549	468	216	154	340	180	300	529,5	95
MBX 28/11 T4 1,1kW	549	468	216	154	340	180	300	453,5	95

Model	J	K	L	M	N	O	P	Q	R
MBX 22/9 T2 1,1kW	110	256	220	290	256	180	204	280	102
MBX 22/9 T2 2,2kW	110	256	220	290	256	180	204	280	102
MBX 22/9 T4 0,37kW	110	256	220	290	256	180	204	280	102
MBX 25/10 T2 2,2kW	134	282	228	315	290	205	229	306	114,5
MBX 25/10 T2 3kW	134	282	228	315	290	205	229	306	114,5

Model	J	K	L	M	N	O	P	Q	R
MBX 25/10 T4 0,75kW	134	282	228	315	290	205	229	306	114,5
MBX 28/11 T2 4kW	144	320	245	350	340	220	244	348	111,5
MBX 28/11 T4 1,1kW	144	320	245	350	340	220	244	348	111,5

Model	S	TØ	UØ	VØ	Z1Ø
MBX 22/9 T2 1,1kW	282	9	180	9	11
MBX 22/9 T2 2,2kW	282	9	180	9	11
MBX 22/9 T4 0,37kW	282	9	180	9	11
MBX 25/10 T2 2,2kW	314	9	203	9	13
MBX 25/10 T2 3kW	314	9	203	9	13
MBX 25/10 T4 0,75kW	314	9	203	9	13
MBX 28/11 T2 4kW	364	9	228	9	13
MBX 28/11 T4 1,1kW	364	9	228	9	13

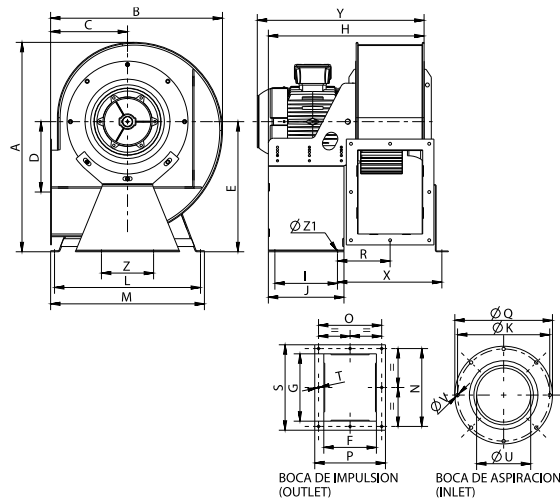

Model	A	B	C	D	E	F	G	H	I
MBX 31/12 T4 2,2kW	640	531	249	180	406	198	319	538	240
MBX 35/14 T4 3kW	715	587	270	242	451	224	280	564	240
MBX 35/14 T4 4kW	715	587	270	242	451	224	280	564	240
MBX 35/14 T6 1,1kW	715	587	270	242	451	224	280	564	240
MBX 40/16 T4 5,5kW	796	652	295	271	499	250	320	595	240
MBX 40/16 T4 7,5kW	796	652	295	271	499	250	320	595	240
MBX 40/16 T6 1,5kW	796	652	295	271	499	250	320	595	240
MBX 45/18 T4 7,5kW	887	730	329	305	553	280	360	791	250
MBX 45/18 T4 11kW	887	730	329	305	553	280	360	791	400
MBX 45/18 T6 2,2kW	887	730	329	305	553	280	360	791	250

Model	J	K	L	M	N	O	P	Q	R
MBX 31/12 T4 2,2kW	290	354,5	457	482	360	240	274	382	171
MBX 35/14 T4 3kW	290	394,5	449	474	318	266	300	422	184
MBX 35/14 T4 4kW	290	394,5	449	474	318	266	300	422	184
MBX 35/14 T6 1,1kW	290	394,5	449	474	318	266	300	422	184
MBX 40/16 T4 5,5kW	290	438	560	590	370	300	336	464	202
MBX 40/16 T4 7,5kW	290	438	560	590	370	300	336	464	202
MBX 40/16 T6 1,5kW	290	438	560	590	370	300	336	464	202
MBX 45/18 T4 7,5kW	300	485	602	632	404	328	356	515	207
MBX 45/18 T4 11kW	300	485	602	632	404	328	356	515	207
MBX 45/18 T6 2,2kW	300	485	602	632	404	328	356	515	207

Model	S	TØ	UØ	VØ	X	Y	Z	Z1
MBX 31/12 T4 2,2kW	395	11	203	11	-	539,5	-	13
MBX 35/14 T4 3kW	356	11	228	11	-	565,75	-	13
MBX 35/14 T4 4kW	356	11	228	11	-	600	-	13
MBX 35/14 T6 1,1kW	356	11	228	11	-	540	-	13
MBX 40/16 T4 5,5kW	406	11	257	11	400	667,75	200	13
MBX 40/16 T4 7,5kW	406	11	257	11	400	707,75	200	13
MBX 40/16 T6 1,5kW	406	11	257	11	400	612,75	200	13
MBX 45/18 T4 7,5kW	436	11	289	11	415	726,75	200	13
MBX 45/18 T4 11kW	436	11	289	11	438	802,75	200	13
MBX 45/18 T6 2,2kW	436	11	289	11	415	631,75	200	13

Wiring diagram

DIAGRAM N° 1

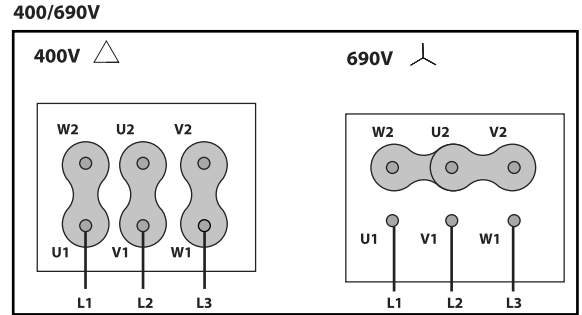
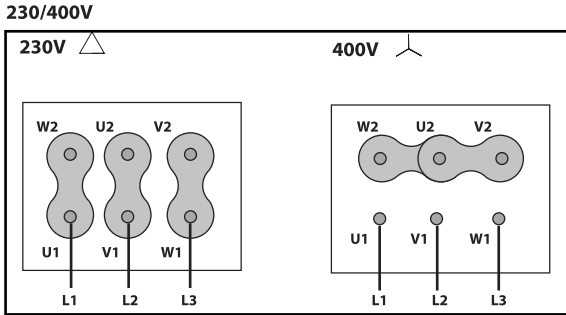

CHARACTERISTIC CURVE

- 1 MBX 14/5 M2 0,25kW
- 2 MBX 16/6 M2 0,37kW
- 3 MBX 18/7 M2 0,75kW
- 4 MBX 20/6 M2 0,37kW
- 5 MBX 20/8 M2 1,1kW

AIR FLOW - PRESSURE

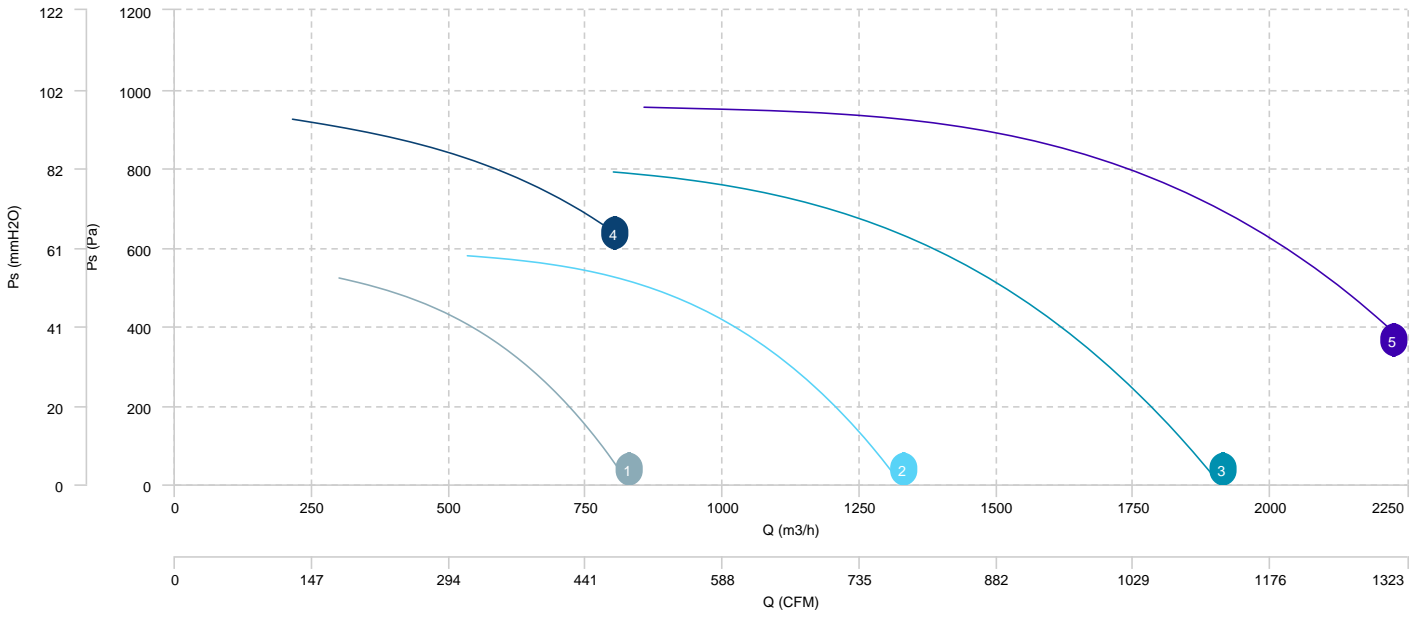

AIR FLOW - ABSORBED POWER

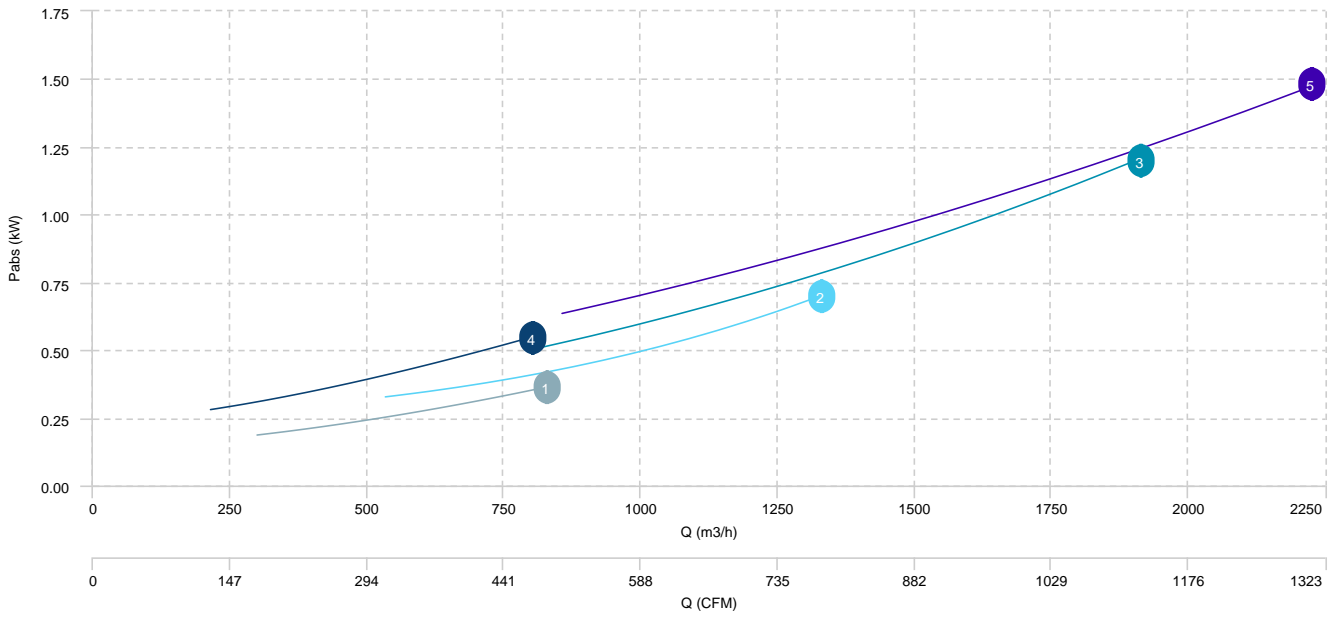

1 MBX 12/5 M4 0,08kW

2 MBX 14/5 M4 0,08kW

3 MBX 16/6 M4 0,08kW

AIR FLOW - PRESSURE

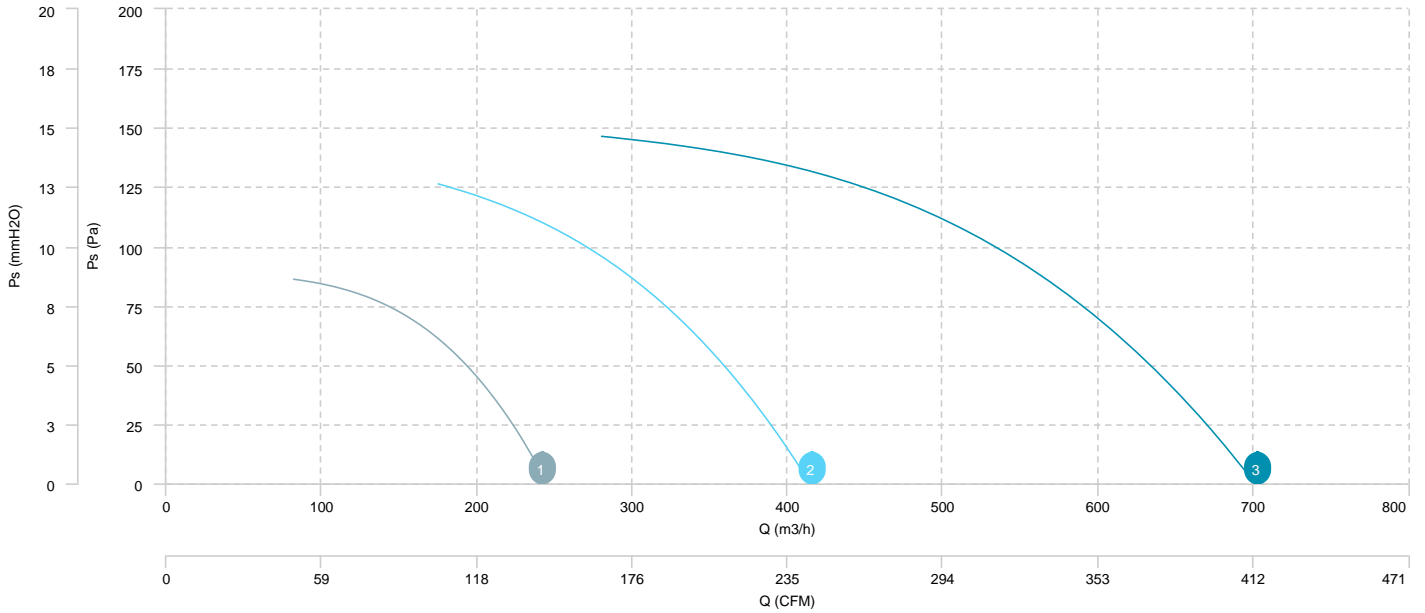

AIR FLOW - ABSORBED POWER

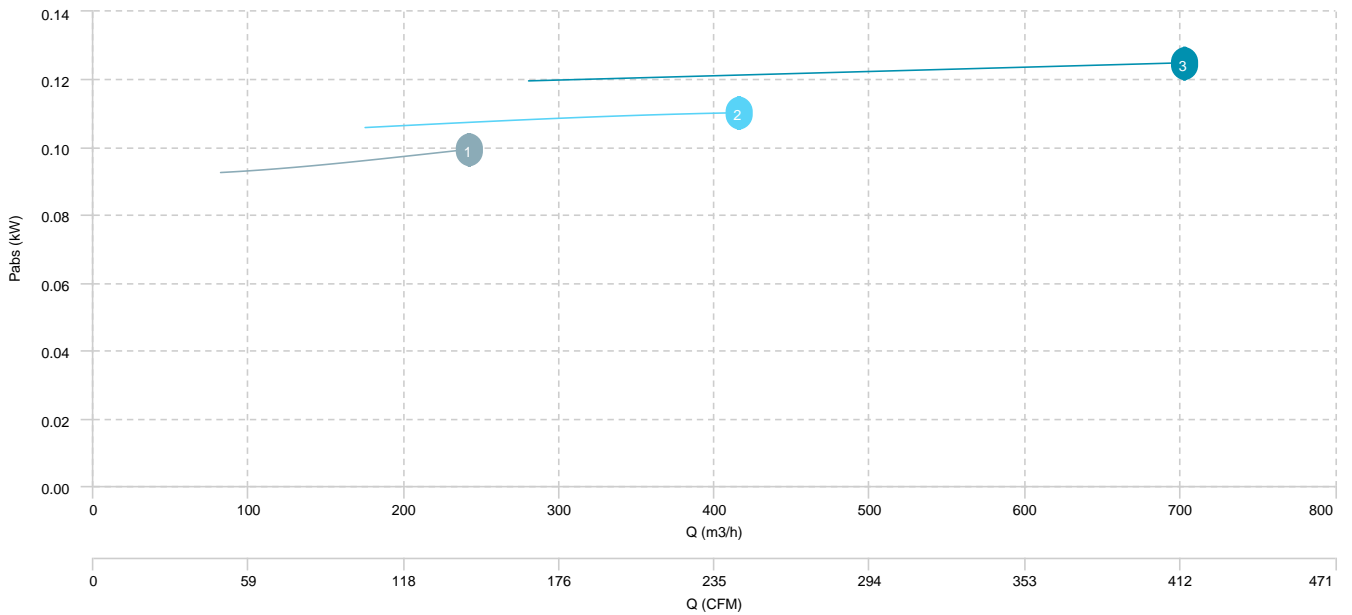

1	MBX 14/5 T2 0,25kW	2	MBX 16/6 T2 0,37kW	3	MBX 18/7 T2 0,75kW	4	MBX 20/6 T2 0,37kW
5	MBX 20/8 T2 1,1kW	6	MBX 22/9 T2 1,1kW	7	MBX 22/9 T2 2,2kW	8	MBX 25/10 T2 2,2kW
9	MBX 25/10 T2 3kW	10	MBX 28/11 T2 4kW				

AIR FLOW - PRESSURE

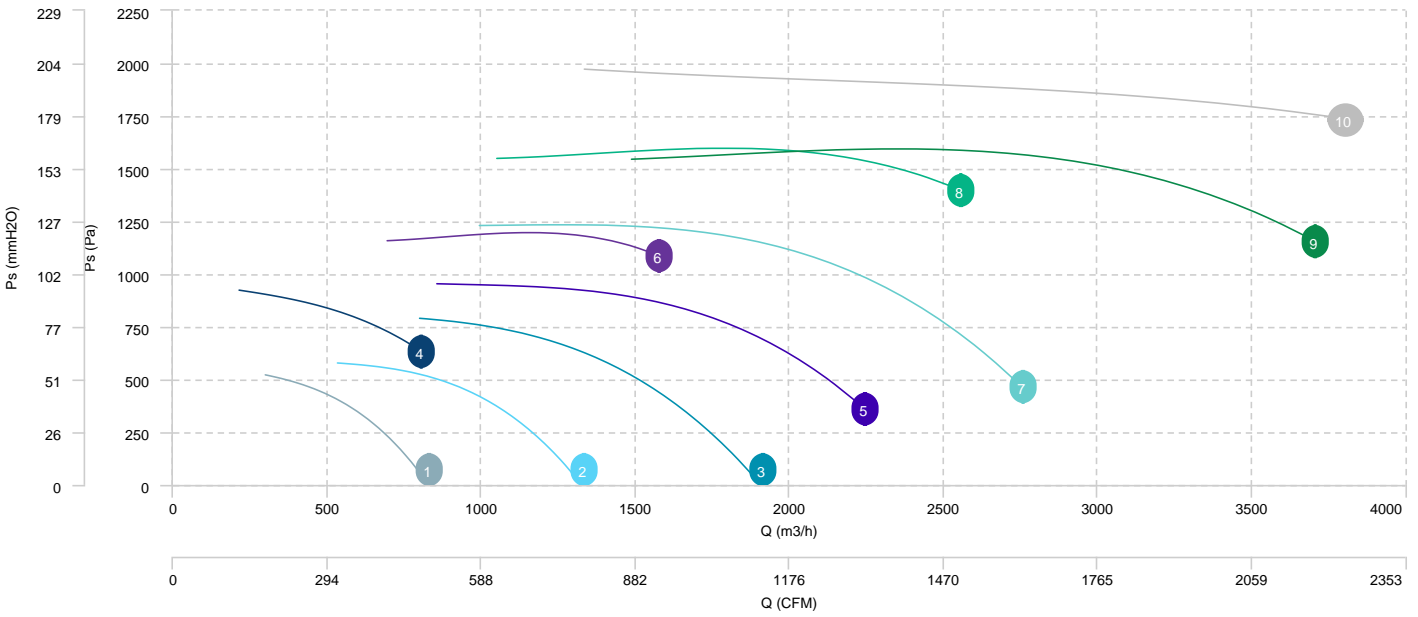

AIR FLOW - ABSORBED POWER

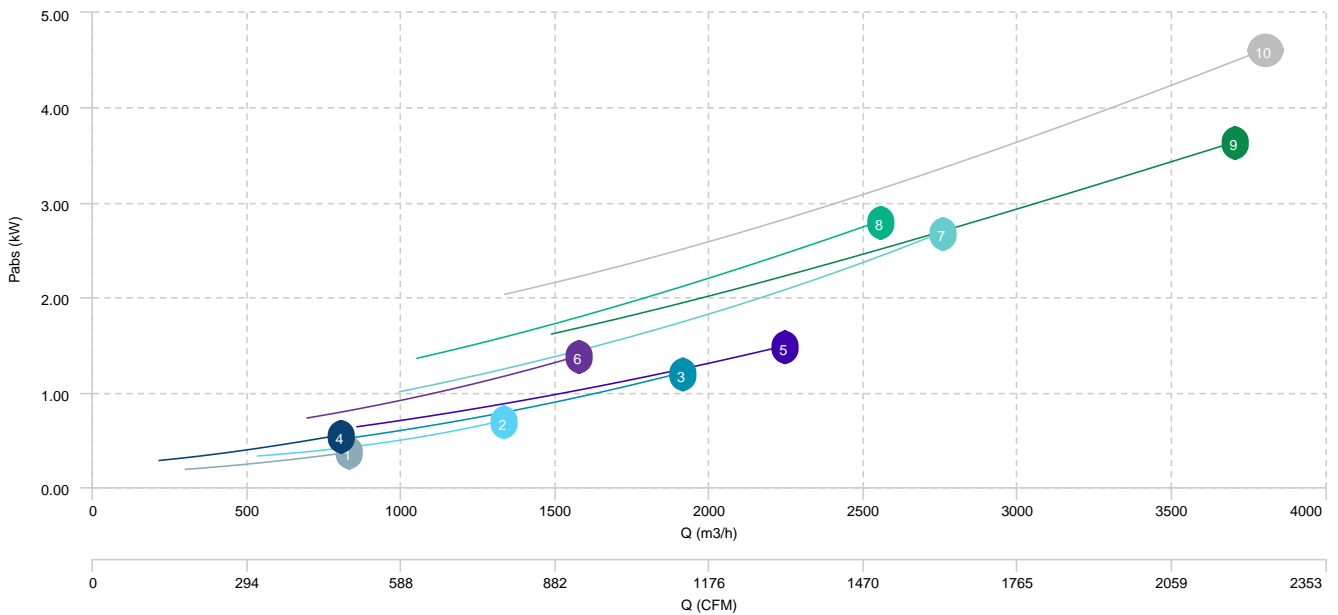

1	MBX 12/5 T4 0,08kW	2	MBX 14/5 T4 0,08kW	3	MBX 16/6 T4 0,08kW	4	MBX 22/9 T4 0,37kW
5	MBX 25/10 T4 0,75kW	6	MBX 28/11 T4 1,1kW	7	MBX 31/12 T4 2,2kW		

AIR FLOW - PRESSURE

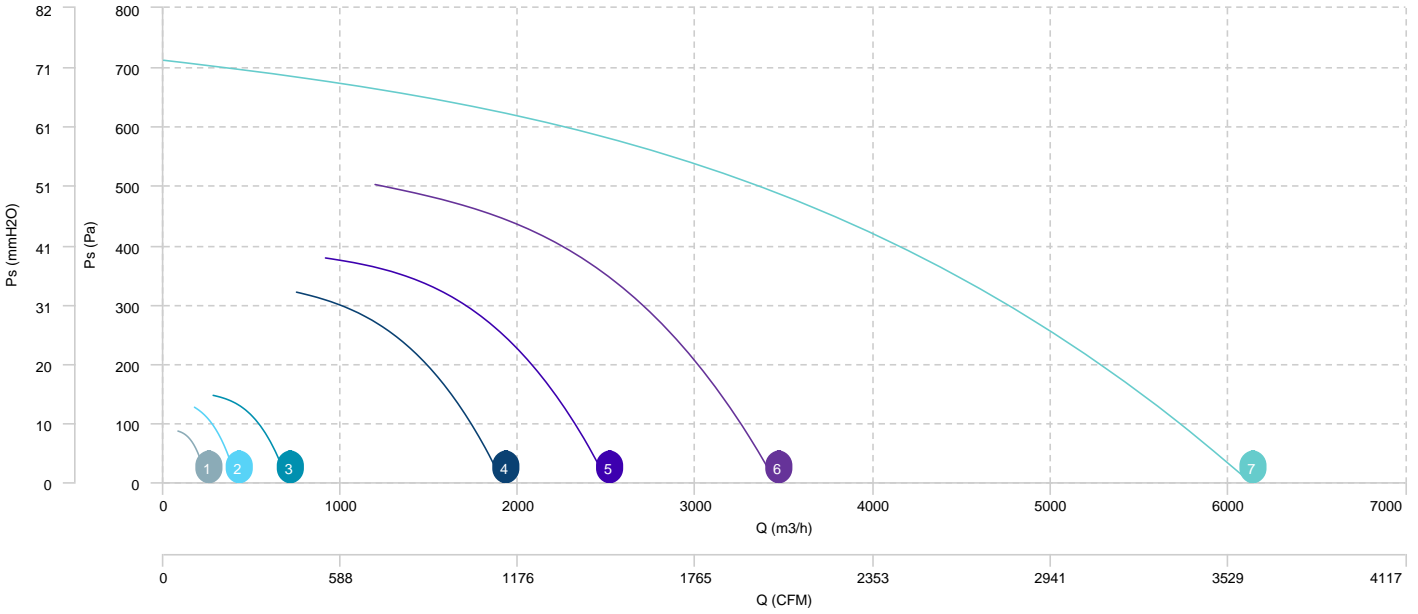

AIR FLOW - ABSORBED POWER

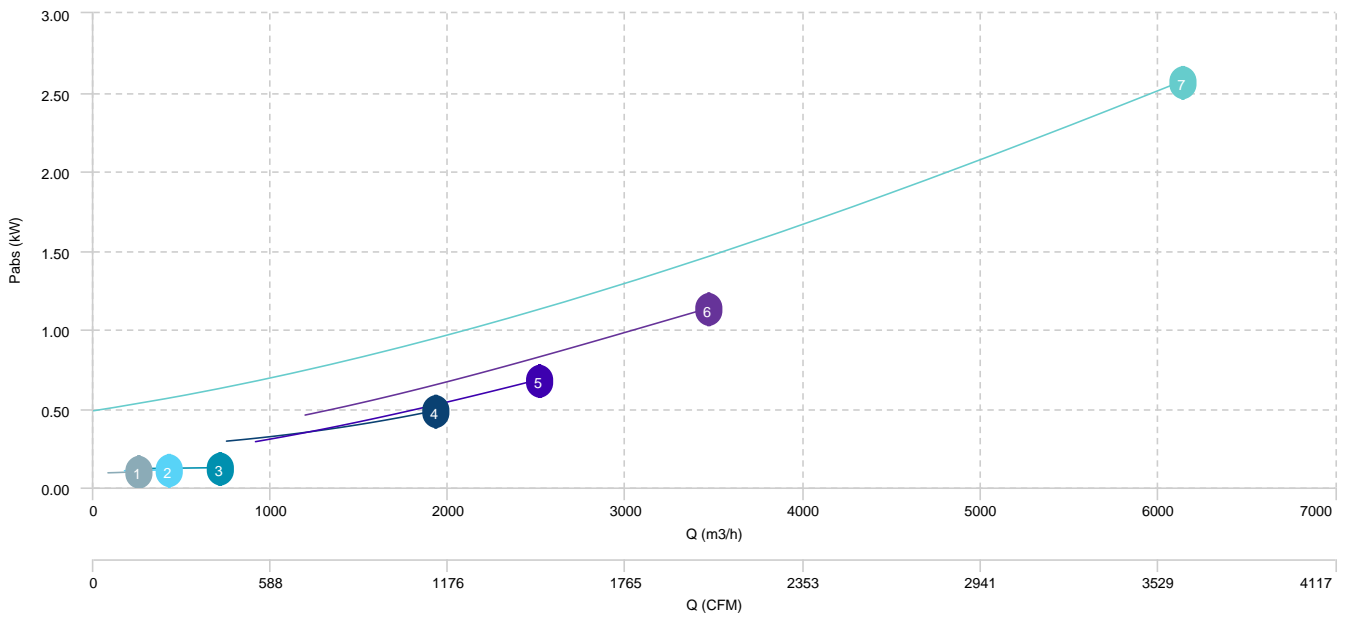

1	MBX 35/14 T4 3kW	2	MBX 35/14 T4 4kW	3	MBX 40/16 T4 5,5kW	4	MBX 40/16 T4 7,5kW
5	MBX 45/18 T4 7,5kW	6	MBX 45/18 T4 11kW				

AIR FLOW - PRESSURE

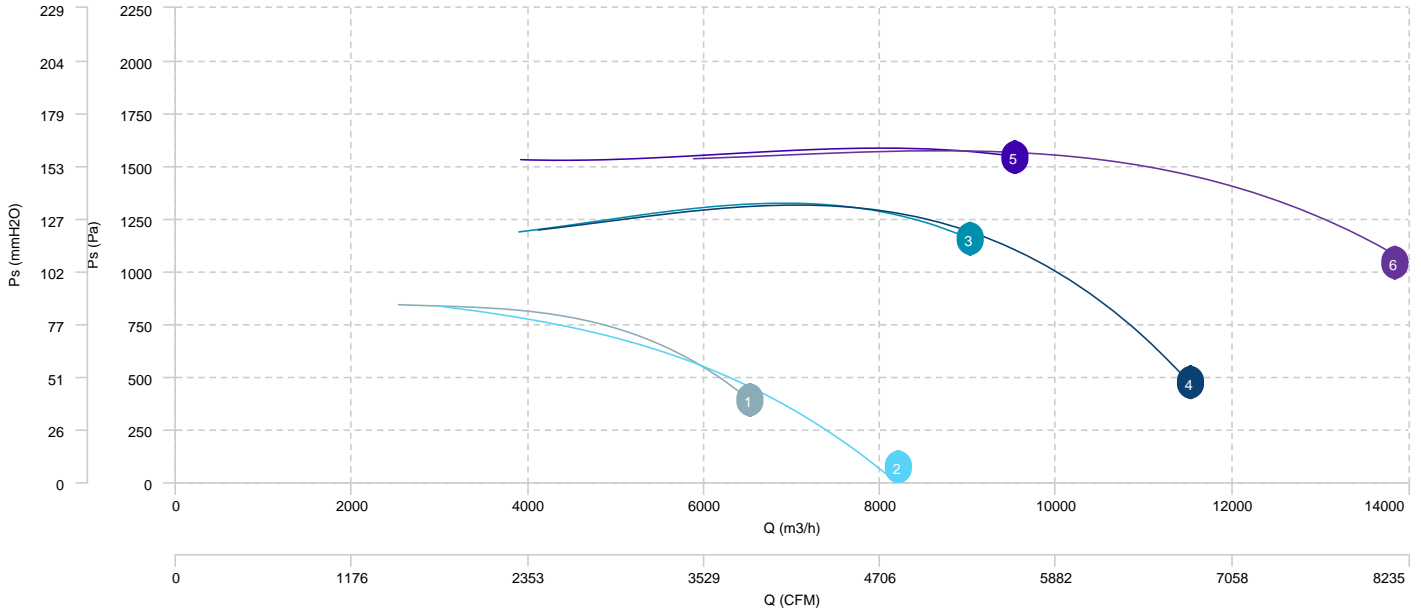

AIR FLOW - ABSORBED POWER

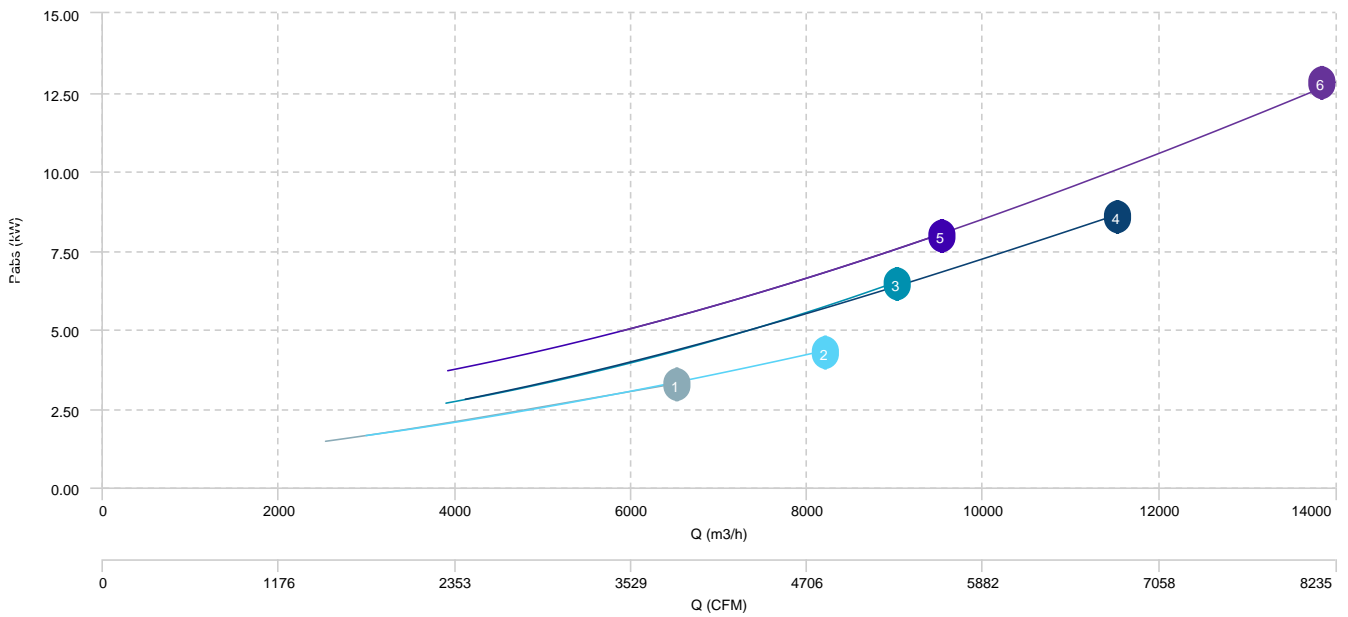

1 MBX 35/14 T6 1,1kW

2 MBX 40/16 T6 1,5kW

3 MBX 45/18 T6 2,2kW

AIR FLOW - PRESSURE

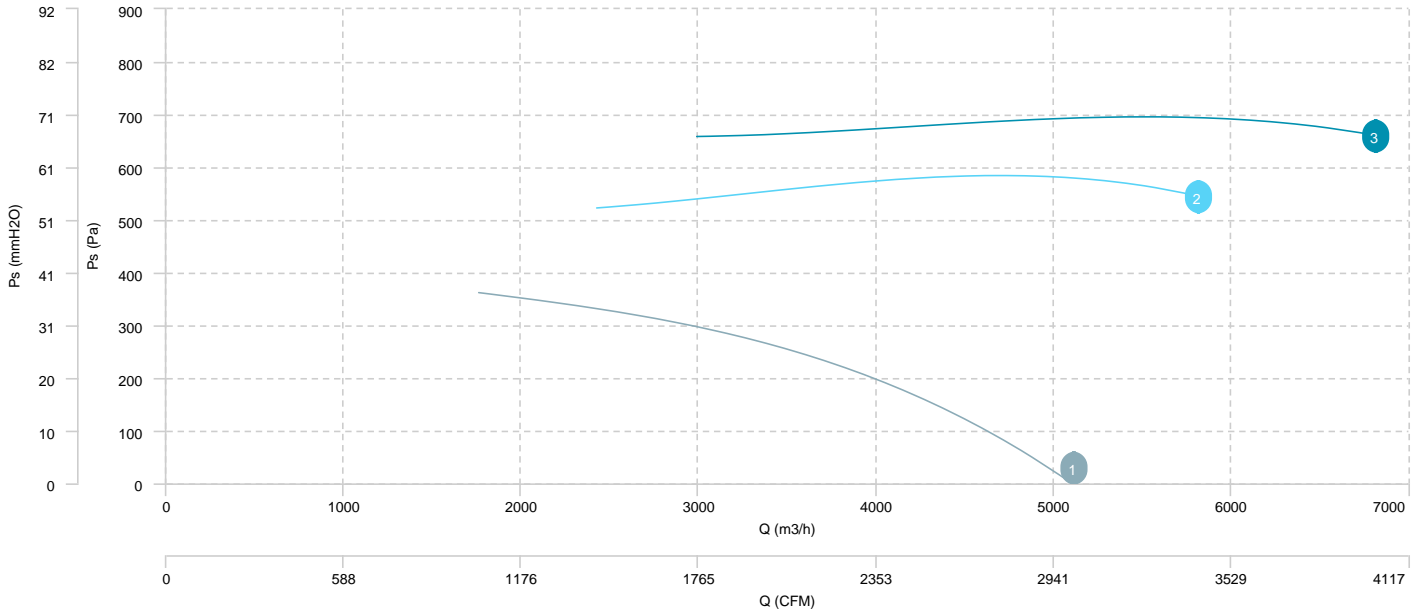

AIR FLOW - ABSORBED POWER

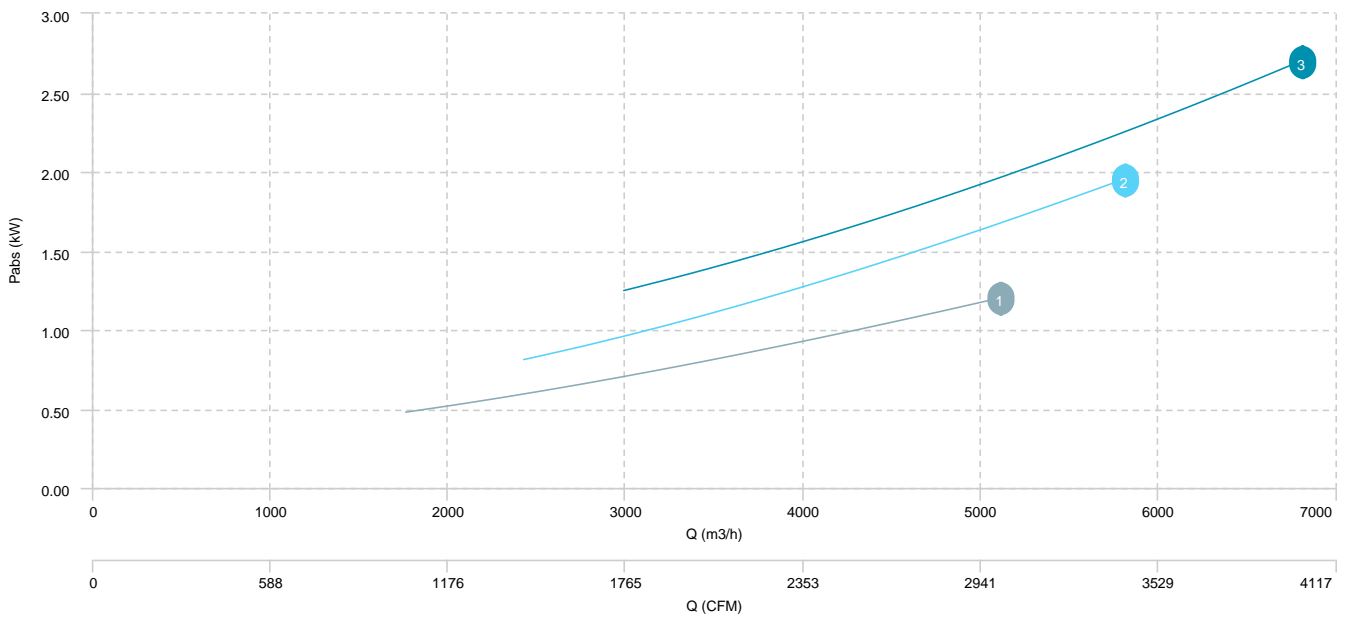

Sound data

Sound / 2 poles

Sound power Lw dB (A)										
Model		63 Hz	125 Hz	250 Hz	500 Hz	1000 Hz	2000 Hz	4000 Hz	8000 Hz	Total
MBX 14/5 M2 0,25kW	Inlet	49	60	71	74	76	80	76	74	84
MBX 14/5 T2 0,25kW	Inlet	49	60	71	74	76	80	76	74	84
MBX 16/6 M2 0,37kW	Inlet	51	63	74	77	79	83	78	76	86
MBX 16/6 T2 0,37kW	Inlet	51	63	74	77	79	83	78	76	86
MBX 18/7 M2 0,75kW	Inlet	54	65	76	79	81	85	81	79	89
MBX 18/7 T2 0,75kW	Inlet	54	65	76	79	81	85	81	79	89
MBX 20/6 M2 0,37kW	Inlet	52	63	74	77	79	83	79	77	87
MBX 20/6 T2 0,37kW	Inlet	52	63	74	77	79	83	79	77	87
MBX 20/8 M2 1,1kW	Inlet	56	68	79	82	84	88	83	82	91
MBX 20/8 T2 1,1kW	Inlet	56	68	79	82	84	88	83	82	91
MBX 22/9 T2 1,1kW	Inlet	46	57	68	71	73	77	73	71	81
MBX 22/9 T2 2,2kW	Inlet	56	67	78	81	83	87	83	81	91
MBX 25/10 T2 2,2kW	Inlet	53	64	75	78	80	84	80	78	88
MBX 25/10 T2 3kW	Inlet	57	68	79	83	85	88	84	82	92
MBX 28/11 T2 4kW	Inlet	61	72	83	86	88	92	88	86	96

Sound / 4 poles

Sound power Lw dB (A)										
Model		63 Hz	125 Hz	250 Hz	500 Hz	1000 Hz	2000 Hz	4000 Hz	8000 Hz	Total
MBX 12/5 M4 0,08kW	Inlet	42	55	61	62	67	68	64	61	72
MBX 12/5 T4 0,08kW	Inlet	42	55	61	62	67	68	64	61	72
MBX 14/5 M4 0,08kW	Inlet	42	55	61	62	67	68	64	61	72
MBX 14/5 T4 0,08kW	Inlet	42	55	61	62	67	68	64	61	72
MBX 16/6 M4 0,08kW	Inlet	49	62	68	69	74	75	71	68	79
MBX 16/6 T4 0,08kW	Inlet	49	62	68	69	74	75	71	68	79
MBX 22/9 T4 0,37kW	Inlet	54	66	73	74	79	80	76	72	85
MBX 25/10 T4 0,75kW	Inlet	54	67	73	74	79	80	76	73	85
MBX 28/11 T4 1,1kW	Inlet	60	73	79	80	85	86	82	79	91
MBX 31/12 T4 2,2kW	Inlet	58	71	77	78	83	84	80	77	89
MBX 35/14 T4 3kW	Inlet	60	73	79	80	85	86	82	79	91
MBX 35/14 T4 4kW	Inlet	59	72	78	79	84	85	81	78	90
MBX 40/16 T4 5,5kW	Inlet	63	76	82	83	88	89	85	82	94
MBX 40/16 T4 7,5kW	Inlet	67	80	86	87	92	93	89	86	98

Sound power Lw dB (A)										
Model		63 Hz	125 Hz	250 Hz	500 Hz	1000 Hz	2000 Hz	4000 Hz	8000 Hz	Total
MBX 45/18 T4 7,5kW	Inlet	70	83	89	90	95	96	92	89	101
MBX 45/18 T4 11kW	Inlet	71	84	90	91	96	97	93	90	102

Sound / 6 poles

Sound power Lw dB (A)										
Model		63 Hz	125 Hz	250 Hz	500 Hz	1000 Hz	2000 Hz	4000 Hz	8000 Hz	Total
MBX 35/14 T6 1,1kW	Inlet	53	66	72	73	78	79	75	72	84
MBX 40/16 T6 1,5kW	Inlet	56	68	71	79	79	80	76	72	85
MBX 45/18 T6 2,2kW	Inlet	60	73	76	84	84	85	80	76	90